

Installation Procedures With Timber-Frame

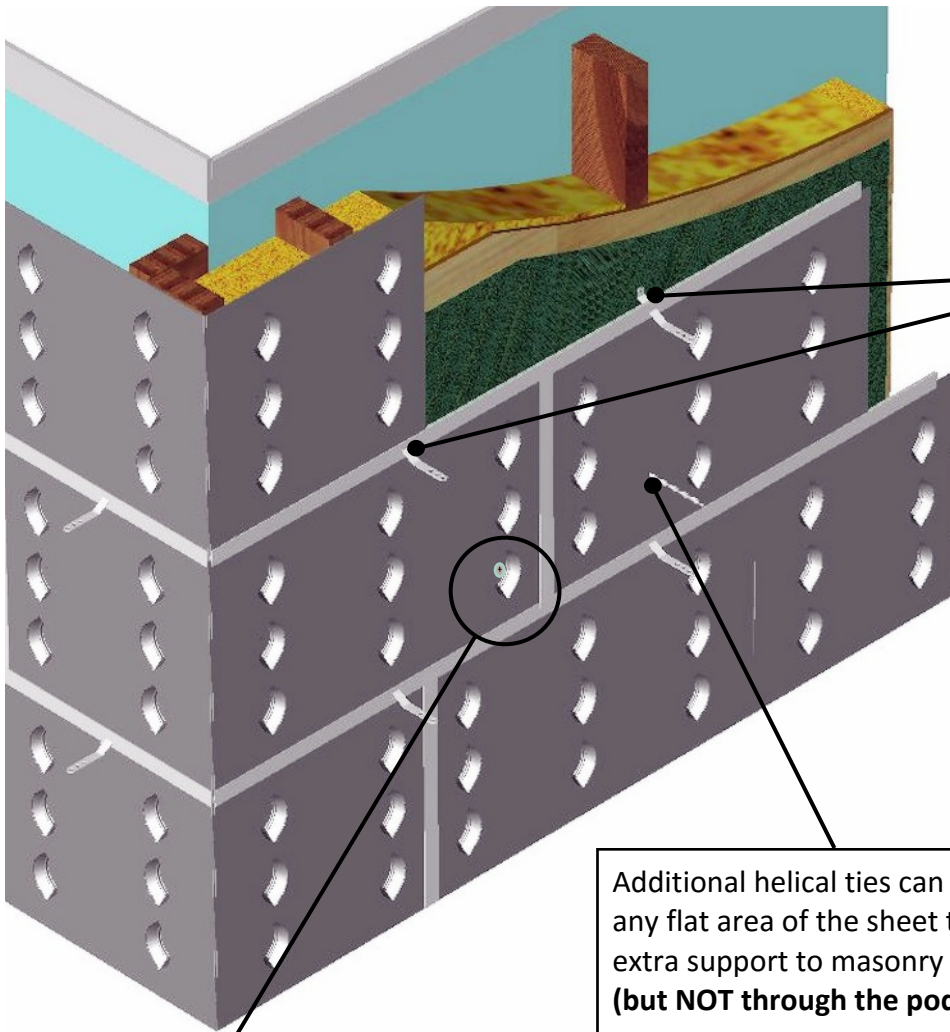

Align all the ties with main timber-frame studding.

Ties are placed every 450mm vertically, to coincide with the SureCav joints.

Cut the horizontal joining strip to fit up to the tie and then continue the joint using the off-cut.

If you need extra ties for random stonework, screw the tie into the back of the SureCav pod using the special seal washer.

Additional helical ties can be used in any flat area of the sheet to provide extra support to masonry as necessary **(but NOT through the pods)**.

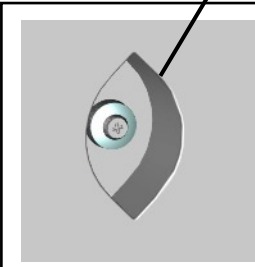

Special seal-washers* can be screwed through the pods to fix the whole system to the timber-frame sheathing, enabling the whole building to be clad, prior to the start of building the external leaf.

Additional masonry support ties can also be fixed through the pods using the seal washers (see overleaf for illustration).

Notes:

1. It is recommended that the joints of the SureCav panels are staggered to add strength to the system.
2. Do not cut the panels through the pods. If a cut coincides with the pods then simply shorten the length and insert a new SureCav section using the vertical joining strips.
3. It is recommended that an additional wall tie is included within 225mm of an opening on each board course level to satisfy structural requirements. This procedure will prevent slots having to be made in the SureCav sheet on each course of block-work when building away from a doorway or window reveal.

* Seal-washers can be purchased from SureCav Limited

Installation Procedures With SIP Panels

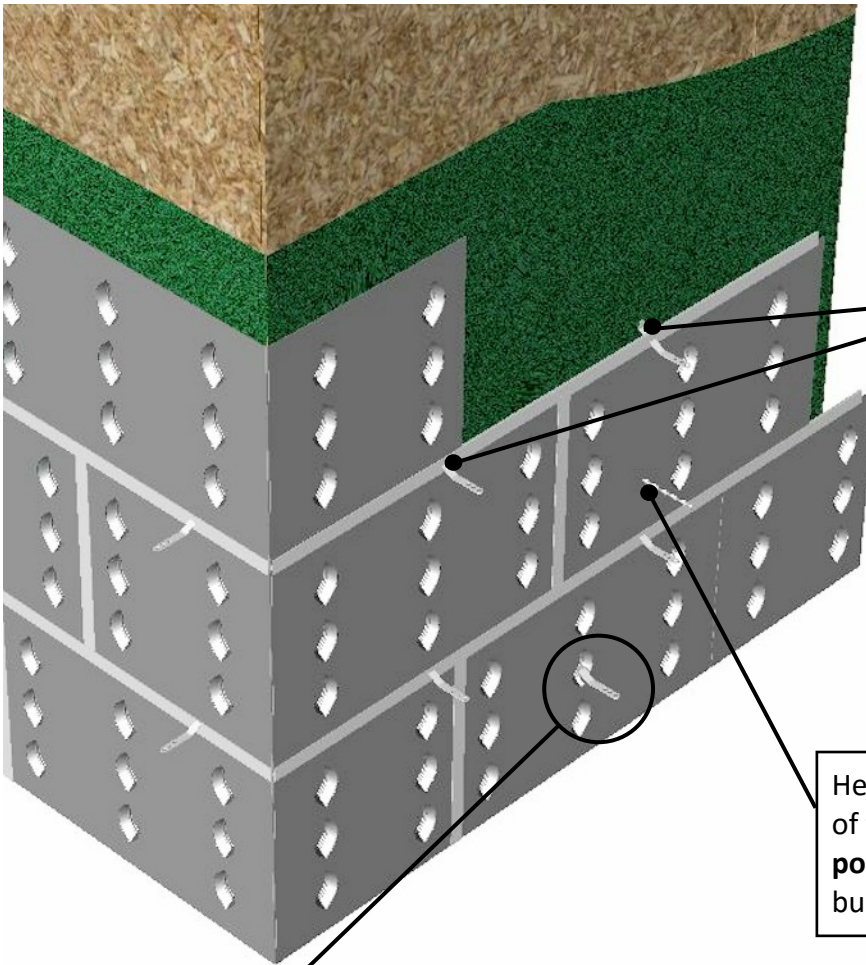

SIP panels do not have main support timbers so the tie can be placed in any suitable position along the length of the SureCav panel.

Ties are placed every 450mm vertically, to coincide with the SureCav joints.

Cut the horizontal joining strip to fit up to the tie and then continue the other side of the tie using the off-cut.

Helical ties can be used in any flat area of the sheet, **but NOT through the pods**. This is especially useful when building with random stonework.

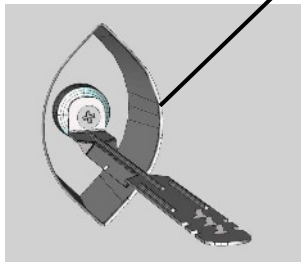

Additional ties can be fixed through any of the pods using special seal washers.*

The seal-washers, used without the tie, can be screwed through the pods to fix the whole system to the SIP sheathing, enabling the whole building to be clad prior to the start of building the external leaf.

Ties shown for illustrative purposes only. Use stainless steel ties approved by LABC

Notes:

1. Stainless steel wall ties can be directly attached to the OSB/3 face of the panel using stainless-steel screw fasteners.
2. It is recommended that the joints of the SureCav panels are staggered to add strength to the system.
3. Do not cut the panels through the pods. If a cut coincides with the pods then simply shorten the length and insert a new SureCav section using the vertical joining strips.
4. It is recommended that an additional wall tie is included within 225mm of an opening on each board course level to satisfy structural requirements. This procedure will prevent slots having to be made in the SureCav sheet on each course of block-work when building away from a doorway or window reveal.

* Seal-washers can be purchased from SureCav Limited