

1. Recommendation for starting corners

Locate the bending line on the sheet and fully bend the sheet back onto its flat face. Now bend the sheet the other way until the pods are touching. Repeat this a couple of times until the sheet stays in the required position. Also, the sheet can be bent to suit corners that are not 90° such as some conservatory walls etc.

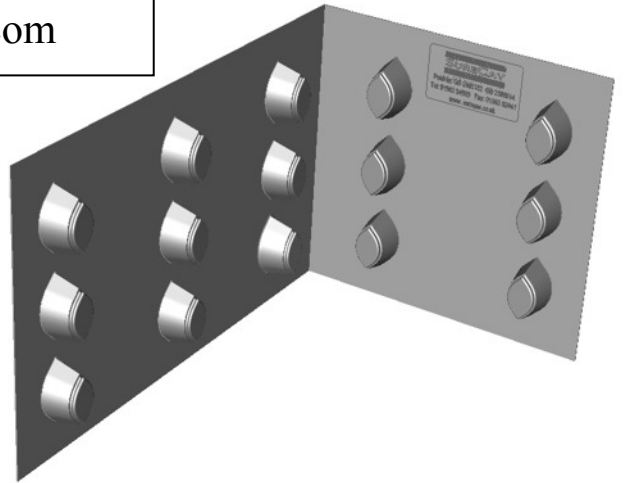

2. When cutting will intersect the pods

Use two cuts or cut off the end of the sheet. Allow enough flat sheet to take the joining strip.

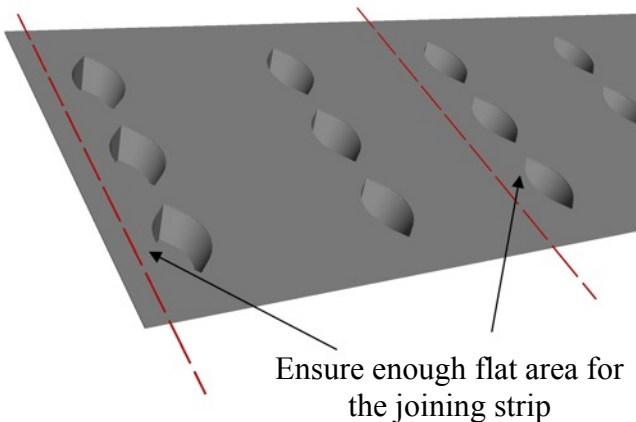

3. Wall ties adjacent to window and door frames

Additional wall ties at 450mm vertical Centres within 225mm of all openings are recommended (as below)

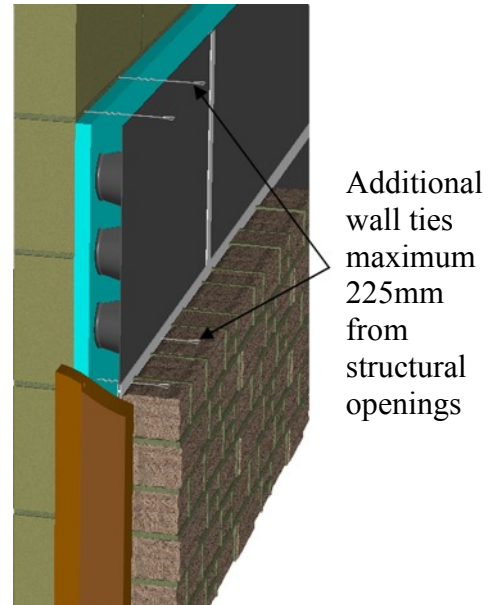

4. Stagger the panels

Stagger the vertical joints as this will strengthen the units.

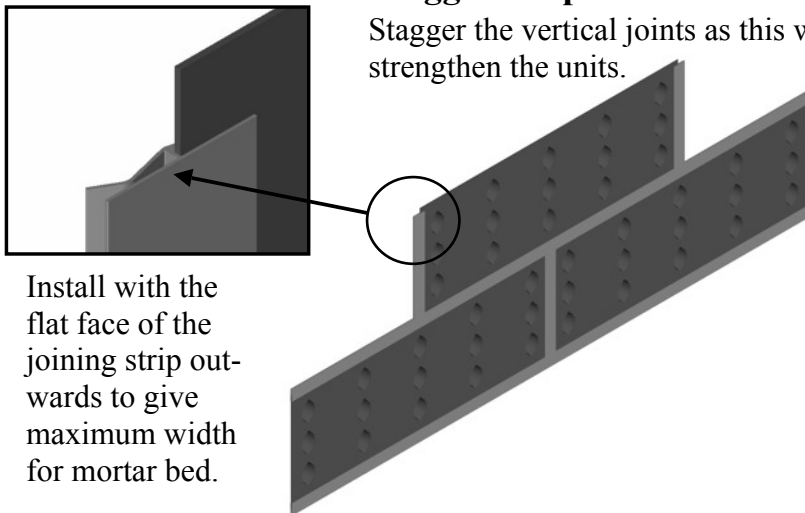

5. Cutting and trimming panels

Cut the panels with tin snips or a saw, or score the panel and then bend it back on itself and the unit will snap off.

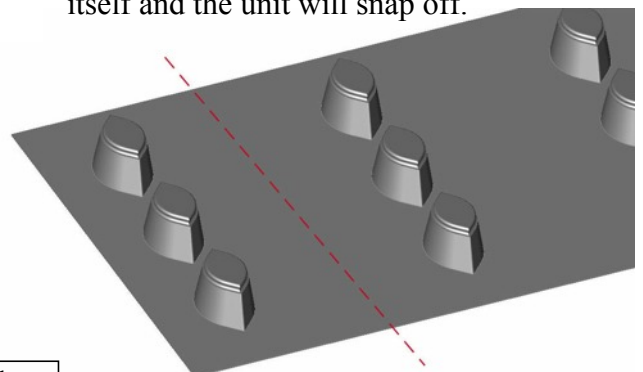

6. Important note about joining strips

The 900mm joining strips are to be used for the horizontal joints. Cut a long joining strip up to a wall tie and use the off-cut to start the next section. The 400mm joining strips are designed to exactly fit the vertical joints of the SureCav panel.

7. Keeping the cavity space clean

When building up the internal wall, ALWAYS ensure that a cavity board or length of timber is used to cover the cavity.

It is **essential** that the cavity is kept free from mortar during construction.

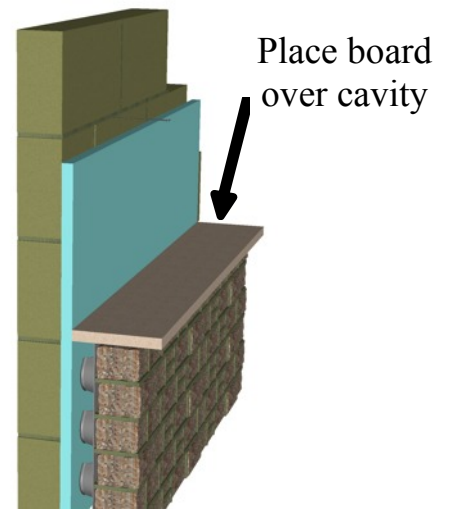

8. Fixing a timber frame tie through the back of a SureCav pod

Sealing washers can be purchased directly from SureCav Ltd.
See our web site for details

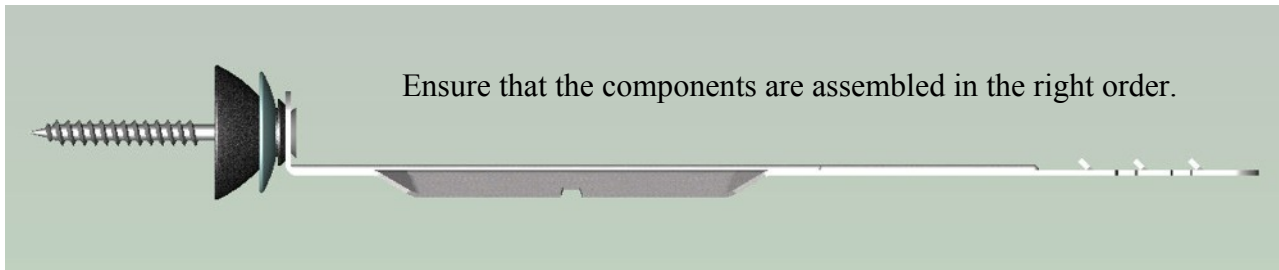

Looking into the open pod the fixings should look as shown below.

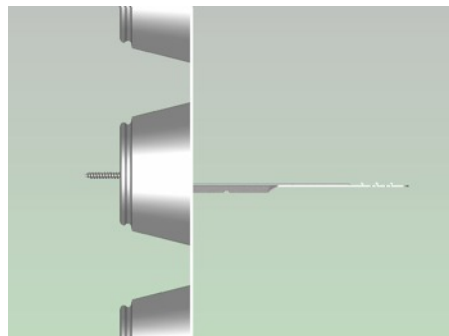
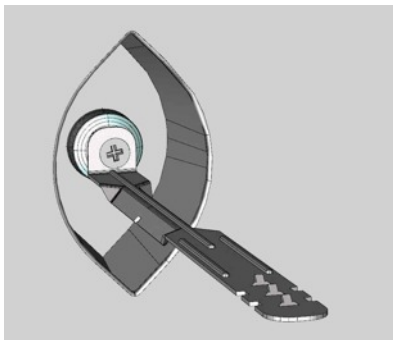

If additional fixings are required and ties are not needed then just fix the Surecav panel through the back of the pod using a screw and sealing washer.

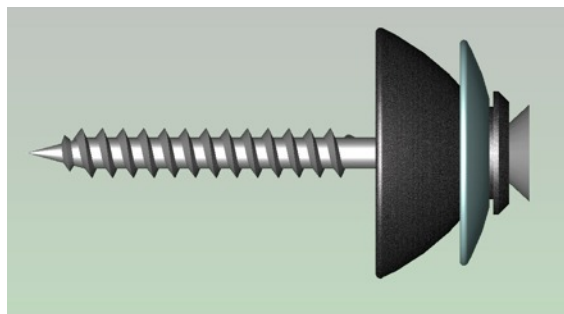
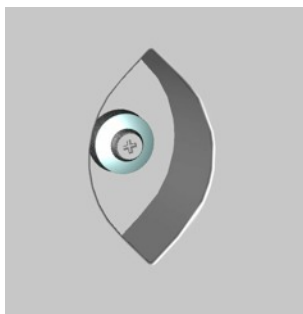

For more instructions using SureCav visit www.surecav.com

SureCav Ltd. Tel: 01963 34660

Copyright © 2011 SureCav Ltd. Published March 2011